

**ROSS TOWNSHIP
KALAMAZOO COUNTY, MICHIGAN**

**RESOLUTION AMENDING CERTAIN FEES/CHARGES PERTAINING
TO THE SHERMAN LAKE PRESSURE SEWER DISTRICT**

WHEREAS, the Township of Ross has heretofore adopted the Sewage Disposal System Ordinance, being Ordinance No. 168 (hereinafter "Ordinance"); and

WHEREAS, pursuant to Section 6 of the Ordinance, the Township Board has authority to amend the rates/amounts of fees and charges imposed under the Ordinance; and

WHEREAS, a pressure sanitary sewer line has recently been completed to provide service to properties within the vicinity of Sherman Lake, which sanitary sewer service area is designated herein as the "Sherman Lake Pressure Sewer District" and is more specifically described in the diagram attached hereto as Exhibit A; and

WHEREAS, properties within or adjacent to the Sherman Lake Pressure Sewer District will soon be connecting to that pressure sanitary sewer line; and

WHEREAS, it is appropriate that this Township Board exercise its above-referenced authority and amend its schedule of sewer fees and charges to establish a specific Connection Fee and Sewer Use Fee for the properties connecting to the pressure sewer line of the Sherman Lake Pressure Sewer District reflective of the costs involved in constructing, operating and maintaining the pressure sanitary sewer line.

NOW, THEREFORE, BE IT HEREBY RESOLVED AS FOLLOWS:

1. That the Sewer Use Fee for properties connecting to the pressure sewer line within the Sherman Lake Pressure Sewer District shall be \$84 per quarter per residential equivalent unit (REU).

2. That the Direct Connection Fee for properties connecting to the pressure sewer line within the Sherman Lake Pressure Sewer District shall initially be \$8,500 for the first REU plus \$3,250 for each REU thereafter. The Direct Connection Fee for the first REU shall increase periodically thereafter as set forth in Exhibit B attached hereto.

3. That the Indirect Connection Fee shall be \$1,625 per REU.

4. That the Sherman Lake YMCA Outdoor Center (hereinafter "Center") shall in accordance with the terms of its contract with the Township dated May 18, 2006, and the payment made by it thereunder, be entitled to connect 100 REU's to the subject pressure sewer line without the payment of any additional connection fee. Any additional REU's connected by the Center to the pressure sewer line shall be subject to the then-current Indirect Connection Fee.

5. That the previously established rates/amounts of all existing fees and charges imposed under the Ordinance shall continue in effect except as expressly amended herein.

6. That this Resolution shall take immediate effect.

7. That all resolutions or parts of resolutions in conflict herewith are hereby repealed.

Motion was made by Genung, seconded by Durham, to adopt the foregoing Resolution.

Upon roll call vote, the following members voted "Aye":

Bither, Durham, Langshaw, Scott, Chambers, Genung
and Murray

The following members voted "Nay": none

The Supervisor declared the motion carried and the Resolution duly adopted.

CERTIFICATE

I hereby certify that the foregoing Resolution was adopted at a regular meeting of the Ross Township Board held at the Township Hall on August 14, 2007; that the meeting was conducted and public notice of the meeting was given pursuant to and in full compliance with the Open Meetings Act of Michigan; that a quorum of the Board was present and voted in favor of the Resolution; and that the minutes of the meeting were kept and will be or have been made available as required by the Open Meetings Act.

Martha Chambers

Martha Chambers, Clerk
Ross Township

Exhibit A
Ross Township
Kalamazoo County, Michigan
Sherman Lake
Pressure Sewer District

July 8, 2003
Revised: February 18, 2005
Revised: August 1, 2007

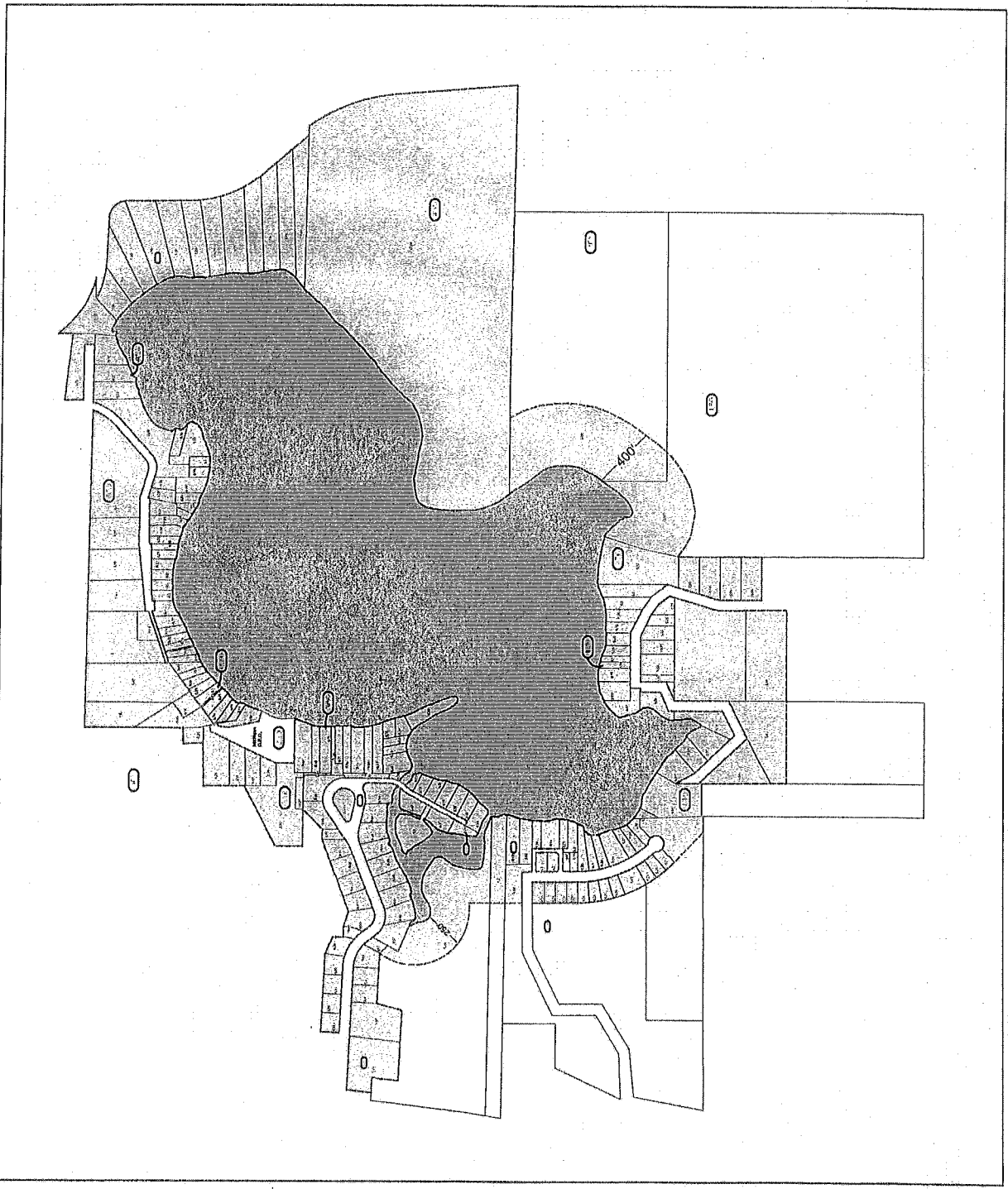
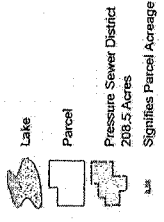
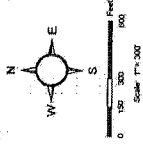

Sherman Lake Pressure Sewer District

7/30/2007

Schedule of Connection Fees per Financing Agreement

Effective Date	Direct Connection Fee for 1st Unit	\$\$ Increase per year	% Increase per year	Direct Connection Fees for 2nd, 3rd, 4th, etc.
Present	\$ 8,500.00			\$ 3,250.00
3/1/2008	\$ 8,696.00	\$ 196.00	2.31%	\$ 3,250.00
3/1/2009	\$ 8,892.00	\$ 196.00	2.25%	\$ 3,250.00
3/1/2010	\$ 9,088.00	\$ 196.00	2.20%	\$ 3,250.00
3/1/2011	\$ 9,284.00	\$ 196.00	2.16%	\$ 3,250.00
3/1/2012	\$ 9,480.00	\$ 196.00	2.11%	\$ 3,250.00
3/1/2013	\$ 9,676.00	\$ 196.00	2.07%	\$ 3,250.00
3/1/2014	\$ 9,872.00	\$ 196.00	2.03%	\$ 3,250.00
3/1/2015	\$ 10,068.00	\$ 196.00	1.99%	\$ 3,250.00
3/1/2016	\$ 10,264.00	\$ 196.00	1.95%	\$ 3,250.00
3/1/2017	\$ 10,460.00	\$ 196.00	1.91%	\$ 3,250.00
3/1/2018	\$ 10,656.00	\$ 196.00	1.87%	\$ 3,250.00
3/1/2019	\$ 10,852.00	\$ 196.00	1.84%	\$ 3,250.00
3/1/2020	\$ 11,048.00	\$ 196.00	1.81%	\$ 3,250.00
3/1/2021	\$ 11,244.00	\$ 196.00	1.77%	\$ 3,250.00
3/1/2022	\$ 11,244.00	\$ 196.00	1.77%	\$ 3,250.00
thereafter	\$ 11,440.00	\$ 196.00	1.74%	\$ 3,250.00

* 2nd, 3rd, 4th unit after the 1st unit is not subject to increase as set forth herein

** Indirect Connection Fee is not subject to increase as set forth herein